

ROWAN



VILMERS

ROWAN



Comfort

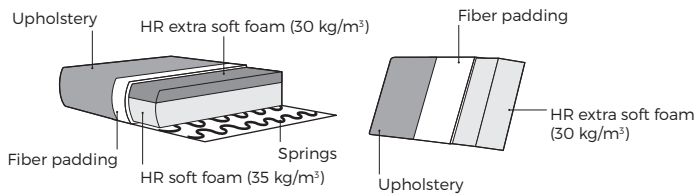

1. Upholstery



* Leather upholstery may require more stitches than fabric upholstery.

2. Headrest & seat type

* Measurements for fully opened mechanism.

- 1 Manual ↘
- 2 Manual ↘
- 3 Manual ↘

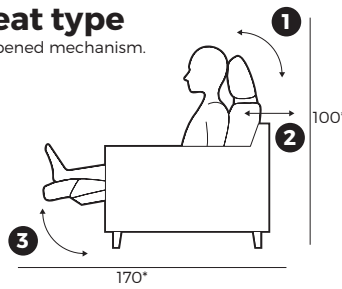

3. Legs

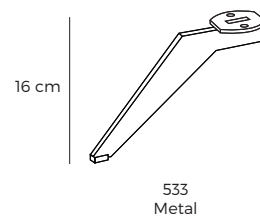

IMPORTANT:

Upholstered furniture is handmade using soft materials, therefore measurements can vary in all modules by up to +/-2 cm. Modules and combinations shown in 2D drawings are left-sided. Modules and combinations can be mirrored from left to right.

Modules

Scale 1:100

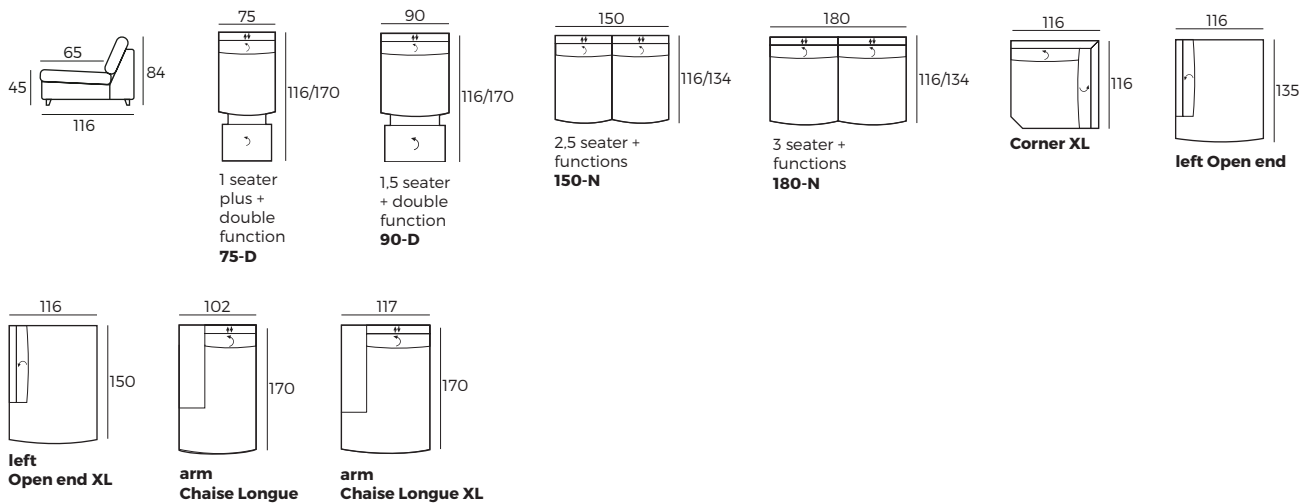

ROWAN

Modules with armrest

Scale 1:100

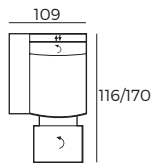

1 seater plus +
double
function
arm 75-D

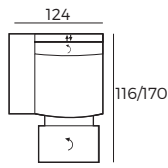

1,5 seater
+ double
function
arm 90-D

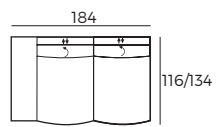

2,5 seater +
function
arm 150-N

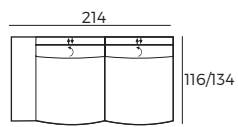

3 seater +
function
arm 180-N

Combinations

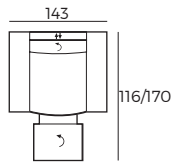

1 seater plus +
double function
arm 75-D arm

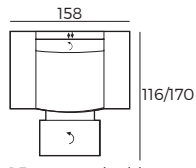

1,5 seater + double
function
arm 90-D arm

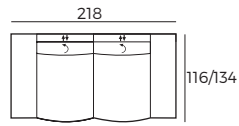

2,5 seater +
function
arm 150-N arm

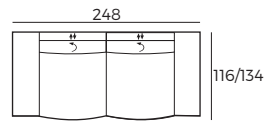

3 seater +
function
arm 180-N arm

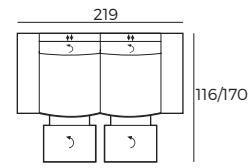

**arm 75-D +
75-D arm**

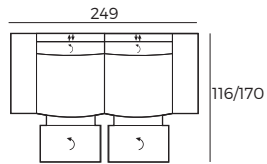

**arm 90-D +
90-D arm**

↶- manual: